

Brede Primary School ICT Suite

Do not scale

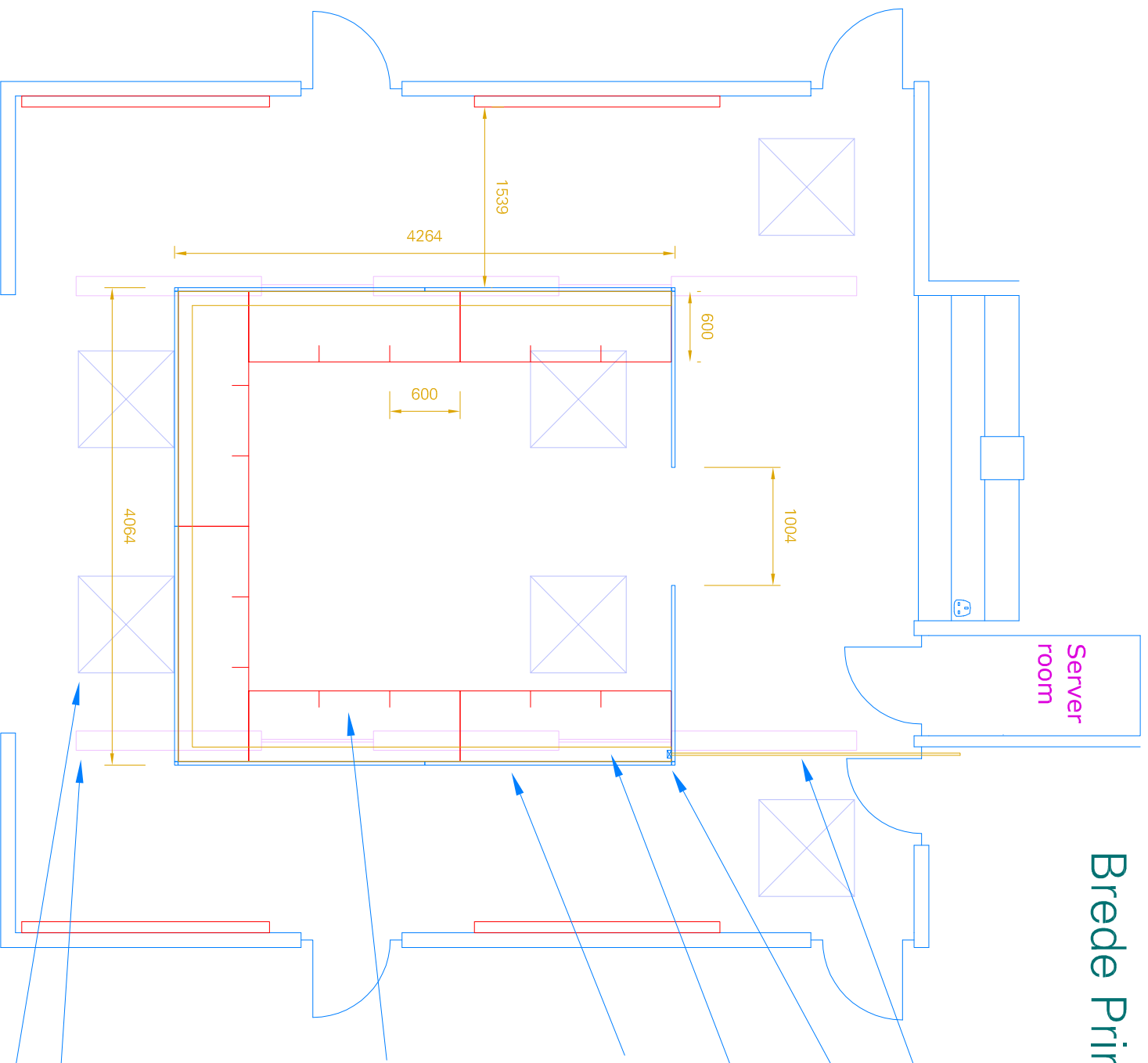

Run round conduit along ceiling to carry 2.5mm ring main from server room to ICT area

- Additions $\frac{35}{8}$ power-pole with 2no 65mm covers
- Secure $\frac{35}{8}$ power-pole to ceiling using 100mm end-trim fixed to right-angled bracket

- Centaur Campus PVC trunking around perimeter of suite
- 8no 2-gang sockets fitted in trunking

- Rigid floor-standing screens which are all mechanically linked to form a rigid, self-standing structure.

- The screens are 1500mm tall to enable staff to see over the top of them, but to prevent students looking over the top (to prevent visual distraction and act as a barrier to noise)

- The screen fabric is a thick Camira Cara weave, laminated with 2mm foam to act as a sound absorber.
- The screen system is modular, so the area could be expanded at a later date.

- The desking is a bench format which allows complete flexibility of seating positions.

- The desk framework is powdercoated steel = robust
- The desktops are white, durable MFC with a plastic edge-band. This ensures that they conform to BS EN 1023 which requires a minimum edge radius of 2mm for safety.
- I have specified the desktop height at 600mm to allow for the range of Yr1 to Yr6 ages. If would like this changed, just let me know and I will amend it.
- I have allowed 600mm workstation space for each student.

Fluorescent lighting

Skylight